



APPLICATION

This line Output Power Transformer series has been developed to provide the required scanning amplitude and EHT for 90° most popular Colour Picture Tubes and to mains insulate the CTV circuit.

The external connections are made by 9 Pins which are directly solderable to the PCB. The Pins 1 to 4 are for the mains connected side while the Pins 6 to 10 are for the output voltages mains insulated. The overwind ground must be connected to pin 8. The magnetic core may be connected to ground by means of a special spring.

The integrated focus potentiometer is internally grounded.

The construction meets the requirements for reinforced insulation according to EN 60065 Standard.

MECHANICAL DIMENSIONS (mm)

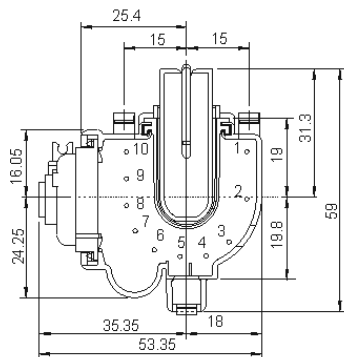

FOOTPRINT (copper side)

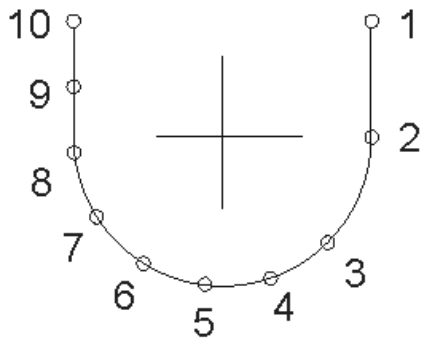

PACKAGING (single box)



WxLxH (mm) 100x60x128

SCHEMATIC DIAGRAM

